

Private Events & Catering

# Slightly TOASTED

COFFEE TOAST WHISKEY BEER

22 N Clinton, Chicago, IL, 60661



The first restaurant Toasted Hospitality created along with local designer Siren Betty, is a love letter to all things whiskey, housing one of the largest collections of whiskey in the world. The space is meant to be an escape from the corporate jungle surrounding it encased in glass, steel, and whiskey barrels.

For Full Buyouts, Slightly Toasted has an interior capacity of 200 standing and 105 seated in the main dining room and up to 75 standing on our Outdoor Patio.

Slightly Toasted features a Full Feature AV System with both Multi Video Capabilities across seven TV's and Multi Channel Audio, Including Wireless Microphone capabilities.

The restaurant can be divided into 2, semi-private spaces.

The **"Bar"** is a semi private space adjacent to the bar and all encompassing whiskey list. It is best used for cocktail and social events, with standing room for 50, or 40 seated.

The **"Fireplace"** is a semi private space that can expand to fit groups from 20-80, with modular seating for either seated or cocktail events. The space is best used for cocktail events up to 80, or seated dinners up to 40, across several tables.

Slightly Toasted's Patio can fit up 75 people standing, or 40 seated on our streetside cafe.

For Larger events, Slightly Toasted also features the **"Rooftop Garden"** which can host cocktail events for up to 750 people, or seated for dinners for up to 200 people. This private space also has independent sound capabilities. This space does come with cleaning and booking fees charged by the building and is best used for larger cocktail events with preset guest lists.

For Tenants of 540 W Madison the space can be booked without fees or preset guest lists.

# Main Dining Room

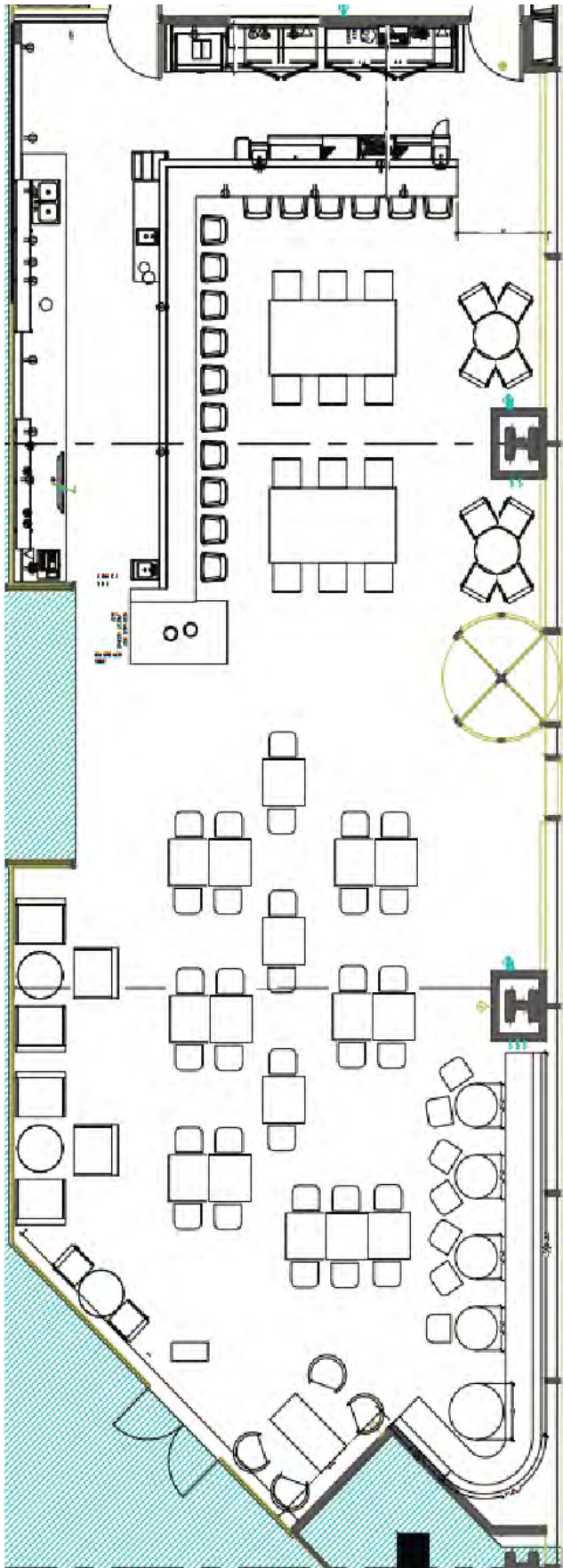

## The "Bar"

Semi Private Capacity for 15-50 people. Best used for cocktail style events. It features 6 TV's, the backdrop of the largest whiskey list in the city, and seating for 40 people.



## The "Fireplace"

Expandable semi private space with a capacity of 25-80 people. Best used for cocktail style events. The space features a custom fireplace, TV with N64, and plenty of standing room to mingle

# The Patio & Rooftop Garden



The **"Patio"** at Slightly Toasted is a convenient streetside cafe space with seating for 40 people and standing room for 70+. This space is best used for cocktail events, or smaller seated groups. The backup weather plan for the patio is the **"Bar"** inside.



The **"Rooftop Garden"** features stunning west views of the cityscape. This space has standing capacity of up to 750 people, and seated capacity of 200 people. The space features multiple garden and grass spaces, fully independent sound, and is over the size of a city block. This space does carry additional cleaning and security fees for non building tenants, and is best used for larger cocktail events, and events with preset guest lists.